



STAINLESS STEEL ECONOMY WORK TABLES



FEATURES:

ELAG Top is furnished with 1 5/8" sanitary rolled rim on front and rear & square ends.

FLAG Top is furnished with 1 5/8" sanitary rolled rim on front and square ends, and 1 1/2" backsplash on rear.

KLAG Top is furnished with 1 5/8" sanitary rolled rim on front and square ends, and 5" backsplash at rear.

Two hat-channels stud welded under tabletop to reinforce and maintain a level work surface.

Aluminum die cast "leg-to-shelf" clamp secures shelf to leg eliminating unsightly nuts and bolts. Undershef is fully adjustable.

CONSTRUCTION:

All TIG welded. Exposed weld areas polished to match adjacent surface.

Top is sound deadened.

Roll formed embossed galvanized hat channels are secured to top by means of structural adhesive and weld studs.

Gussets welded to support hat channels.

MATERIAL:

TOP: 16 gauge stainless steel type "430" series.

SHELF: 18 gauge galvanized steel.

LEGS: 1 5/8" diameter tubular galvanized steel. Galvanized steel gussets.
1" adjustable plastic bullet feet.

Item #: _____ Qty #: _____
 Model #: _____
 Project #: _____



ELAG-X Series
Flat Top



Plastic Bullet Feet standard on
ELAG, FLAG & KLAG Series



FLAG-X Series
1 1/2" Backsplash



KLAG-X Series
5" Backsplash

	L	Model #	WT.		Cu.		Model #	WT.		Cu.	
			Ft.	Lbs.	Ft.	Lbs.		Ft.	Lbs.		
			FLAT TOP			1 1/2" SPLASH			5" SPLASH		
18" WIDE	24"	ELAG-182-X	37 lbs.	4	-	-	-	-	-	-	-
	30"	ELAG-180-X	44 lbs.	4	-	-	-	-	-	-	-
	36"	ELAG-183-X	47 lbs.	4	-	-	-	-	-	-	-
	48"	ELAG-184-X	58 lbs.	5	-	-	-	-	-	-	-
	60"	ELAG-185-X	66 lbs.	7	-	-	-	-	-	-	-
	72"	ELAG-186-X	79 lbs.	8	-	-	-	-	-	-	-
24" WIDE	24"	ELAG-242-X	44 lbs.	4	FLAG-242-X	44 lbs.	4	KLAG-242-X	48 lbs.	7	7
	30"	ELAG-240-X	50 lbs.	4	FLAG-240-X	50 lbs.	4	KLAG-240-X	55 lbs.	7	7
	36"	ELAG-243-X	56 lbs.	4	FLAG-243-X	56 lbs.	4	KLAG-243-X	61 lbs.	7	7
	48"	ELAG-244-X	69 lbs.	6	FLAG-244-X	69 lbs.	6	KLAG-244-X	75 lbs.	9	9
	60"	ELAG-245-X	80 lbs.	7	FLAG-245-X	80 lbs.	7	KLAG-245-X	89 lbs.	11	11
	72"	ELAG-246-X	95 lbs.	8	FLAG-246-X	95 lbs.	8	KLAG-246-X	102 lbs.	13	13
	84"	ELAG-247-X	108 lbs.	10	FLAG-247-X	108 lbs.	10	KLAG-247-X	117 lbs.	15	15
	96"	ELAG-248-X*	112 lbs.	11	FLAG-248-X*	112 lbs.	11	KLAG-248-X*	137 lbs.	17	17
30" WIDE	24"	ELAG-302-X	49 lbs.	5	FLAG-302-X	49 lbs.	5	KLAG-302-X	53 lbs.	8	8
	30"	ELAG-300-X	56 lbs.	5	FLAG-300-X	56 lbs.	5	KLAG-300-X	61 lbs.	8	8
	36"	ELAG-303-X	64 lbs.	5	FLAG-303-X	64 lbs.	5	KLAG-303-X	69 lbs.	8	8
	48"	ELAG-304-X	79 lbs.	7	FLAG-304-X	79 lbs.	7	KLAG-304-X	84 lbs.	11	11
	60"	ELAG-305-X	95 lbs.	8	FLAG-305-X	95 lbs.	8	KLAG-305-X	101 lbs.	13	13
	72"	ELAG-306-X	110 lbs.	10	FLAG-306-X	110 lbs.	10	KLAG-306-X	117 lbs.	16	16
	84"	ELAG-307-X	125 lbs.	12	FLAG-307-X	125 lbs.	12	KLAG-307-X	133 lbs.	18	18
	96"	ELAG-308-X*	131 lbs.	13	FLAG-308-X*	131 lbs.	13	KLAG-308-X*	140 lbs.	20	20
36" WIDE	36"	ELAG-363-X	73 lbs.	6	FLAG-363-X	73 lbs.	6	KLAG-363-X	80 lbs.	10	10
	48"	ELAG-364-X	92 lbs.	8	FLAG-364-X	92 lbs.	8	KLAG-364-X	100 lbs.	13	13
	60"	ELAG-365-X	111 lbs.	10	FLAG-365-X	111 lbs.	10	KLAG-365-X	120 lbs.	15	15
	72"	ELAG-366-X	130 lbs.	12	FLAG-366-X	130 lbs.	12	KLAG-366-X	140 lbs.	18	18
	96"	ELAG-368-X*	158 lbs.	15	FLAG-368-X*	158 lbs.	15	KLAG-368-X*	189 lbs.	24	24

All 8 ft. Tables Provided With 6 Legs



Customer Service Available To Assist You 1-800-645-3166 8:30 am - 8:00 pm E.S.T.

For Orders & Customer Service:

Email: customer@advancetabco.com or Fax: 631-242-6900

For Smart Fabrication™ Quotes:

Email: smartfab@advancetabco.com or Fax: 631-586-2933



DETAILS and SPECIFICATIONS

TOL \pm .500"

ALL DIMENSIONS ARE TYPICAL

ELAG SERIES - Flat Top

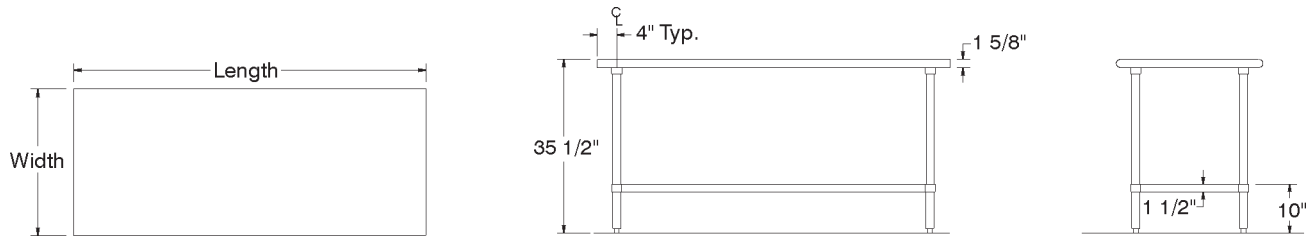

FLAG SERIES - 1 1/2" Backsplash

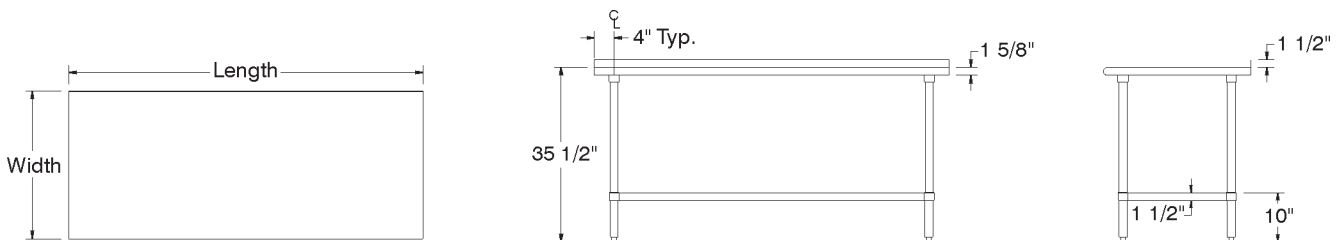

KLAG SERIES - 5" Backsplash

